

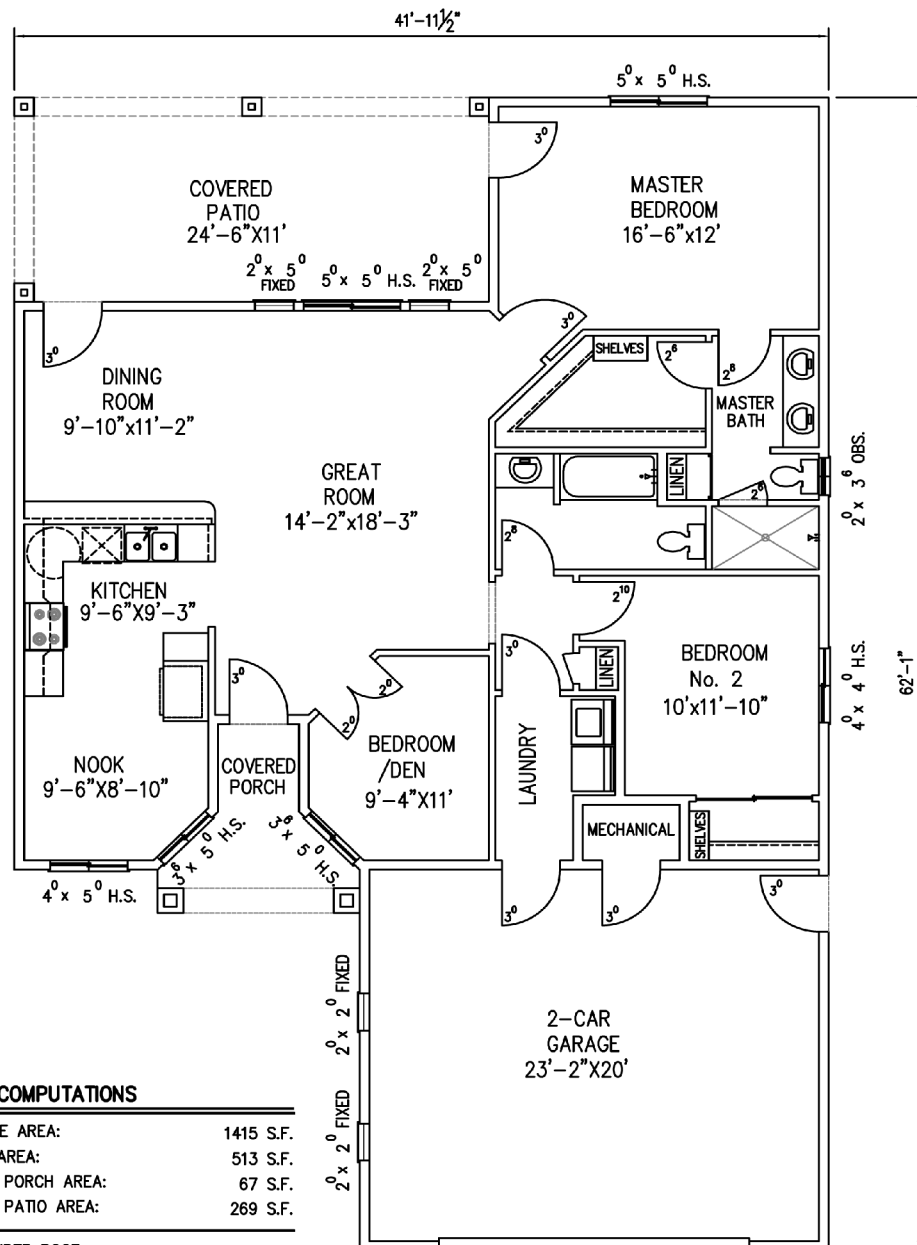

# Model 1415



3 Bedrooms,  
2 Bathrooms,  
2 Car Garage



AREA COMPUTATIONS	
HABITABLE AREA:	1415 S.F.
GARAGE AREA:	513 S.F.
COVERED PORCH AREA:	67 S.F.
COVERED PATIO AREA:	269 S.F.
<b>TOTAL UNDER ROOF:</b>	<b>2267 S.F.</b>

16" x 7" STEEL OVERHEAD GARAGE DOOR  
CONT. 4"x12" DF/L #2 OR BETTER HEADER